

APPROVED

REVISIONS				
ZONE	REV.	DESCRIPTION	DATE	APPROVED
	A	INITIAL RELEASE	6/6/2019	JP

FOR REFERENCE ONLY

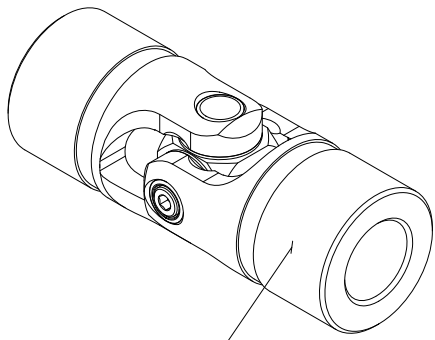

$\left(\begin{matrix} .375 \\ [9.53] \\ \text{GROOVE} \\ \text{TYP} \end{matrix} \right)$

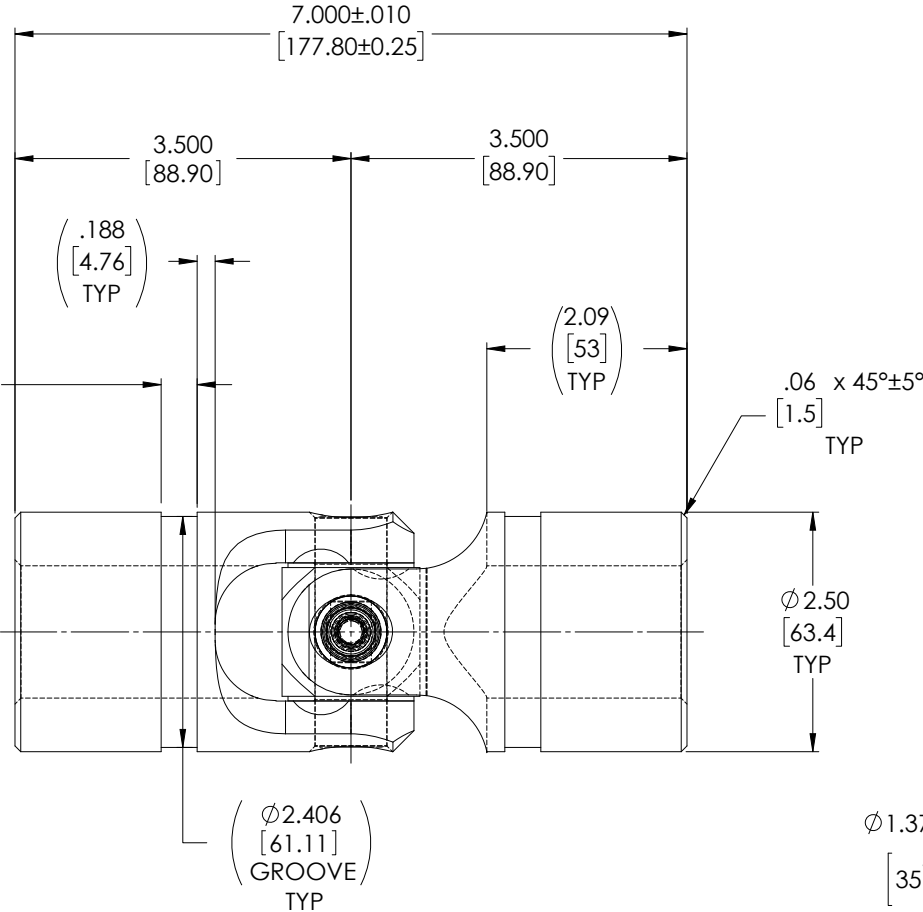

✓ $\phi 1.50 \times 90^\circ \pm 10^\circ \text{ INCL.}$
[38.2]

TYPICAL BOTH ENDS

NOTE(s), UNLESS OTHERWISE SPECIFIED.

- 1 MARK ASSEMBLY w/ "BELDEN" LOGO, PART NUMBER, REVISION LEVEL (IF ANY), DATE OF MANUFACTURE (MO/YR). & BELDEN JOB No.
- (2) LUBRICATE WITH LUBRIPLATE® PRODUCT No. 1200-2 NLGI GRADE 2, AW/EP, LITHIUM GREASE.
- (3) TORQUE M8x1.25 SOCKET HEAD CAP SCREW TO 20 FT-LBS.
- (4) REF., MAXIMUM OPERATING ANGLE: 45°.
- (5) REF., MATERIAL: YOKES... TYPE 303 STAINLESS STEEL, BLOCK & PINS... TYPE 416 STAINLESS STEEL, CAP SCREW.... TYPE 18-8 STAINLESS STEEL, HEX LOCKNUT... TYPE 18-8 STAINLESS STEEL.

DO NOT SCALE DRAWING

UNLESS OTHERWISE SPECIFIED CHAMFER ALL HOLES BREAK ALL SHARP CORNERS DE-BURR ALL FEATURES TURNED SURFACES: \checkmark_{69} MILLED SURFACES: \checkmark_{125} PROPRIETARY AND CONFIDENTIAL THE INFORMATION CONTAINED IN THIS DRAWING IS THE SOLE PROPERTY OF BELDEN UNIVERSAL. ANY REPRODUCTION IN PART OR AS A WHOLE WITHOUT THE WRITTEN PERMISSION OF BELDEN UNIVERSAL IS PROHIBITED.	STANDARD TOLERANCES, UNLESS OTHERWISE SPECIFIED DIMENSIONS ARE IN INCHES (mm)	MATERIAL STAINLESS STEEL	INITIALS DATE DRAWN JP 06/JUN/19	Belden Incorporated www.beldenuniversal.com ASSEMBLY, UNIVERSAL JOINT	
	ANGULAR MACHINED: $\pm 1.0^\circ$ FRACTIONAL: $\pm .015$ TWO PLACE DECIMAL: $\pm .010$ THREE PLACE DECIMAL: $\pm .005$ FOUR PLACE DECIMAL: $\pm .0005$ CONCENTRICITY: $\pm .0025$ T.I.R.	HEAT TREAT SEE DETAIL DRAWINGS	CHECKED RNK 06/24/2019 ENG APPR. MFG APPR. QC APPR.		TITLE:
	ALL HOLES TO BE LOCATED ON CENTERLINE (C) WITHIN .005" T.I.R. INTERPRET GEOMETRIC TOLERANCES I.A.W. ASME Y14.5	FINISH NONE	COMMENTS:		SIZE DWG. NO. REV A UJ-SS2500x35 A
	SCALE: 1:1 WT (Lbs): 6.308 SHEET 1 OF 2				