

REVISIONS				
ZONE	REV.	DESCRIPTION	DATE	APPROVED

**INFORMATION IN THIS DRAWING  
PROVIDED FOR REFERENCE ONLY**

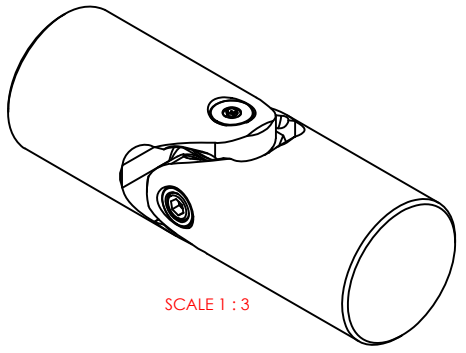

SCALE 1:3

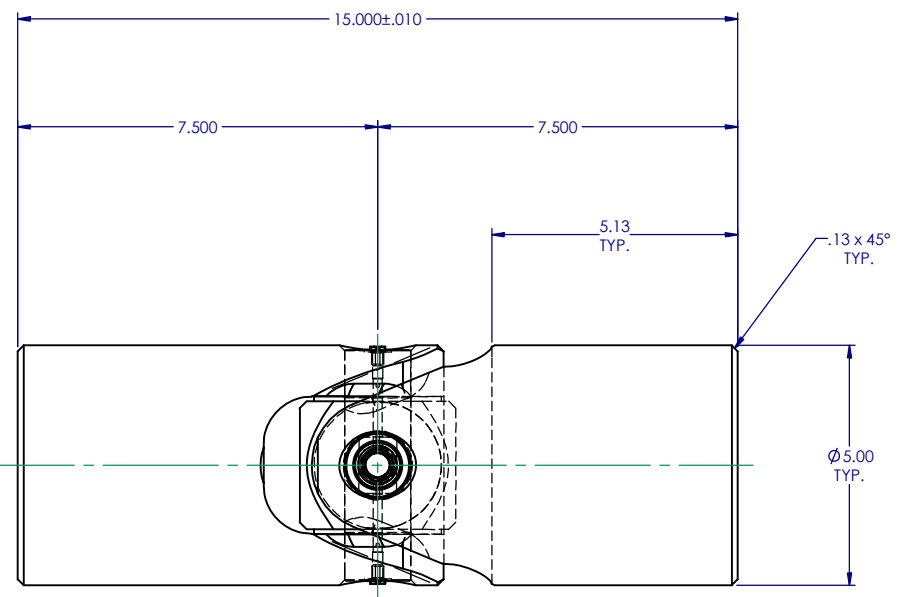

NOTE(s), UNLESS OTHERWISE SPECIFIED.

- (1) MARK ASSEMBLY w/ "BELDEN" LOGO, PART NUMBER, REVISION LEVEL (IF ANY), DATE OF MANUFACTURE, & BELDEN JOB No.
- (2) CLEAN SOCKET HEAD CAP SCREW w/ LOC-TITE PRIMER #17471. APPLY LOC-TITE #2760 THREAD LOCKER TO THREADS OF SHCS. TAKE CARE TO KEEP THREADS FREE OF GREASE, TIGHTEN UNTIL FULLY SEATED & TORQUE TO 120 FT-LBS.
- (3) LUBRICATE w/ LUBRIPLATE PRODUCT No. 3000 MOLY-LITHIUM, EXTREME PRESSURE, NLGI GRADE 2 GREASE OR EQUIVALENT.
- (4) REFERENCE, UNIVERSAL JOINT CAPABLE OF OPERATING AT ANY ANGLE UP TO AND INCLUDING 15°.

DO NOT SCALE DRAWING

UNLESS OTHERWISE SPECIFIED CHAMFER ALL HOLES BREAK ALL SHARP CORNERS DE-BURR ALL FEATURES TURNED SURFACES: $\sqrt{63}$ MILLED SURFACES: $\sqrt{125}$	STANDARD TOLERANCES, UNLESS OTHERWISE SPECIFIED DIMENSIONS ARE IN INCHES [mm]	MATERIAL ALLOY STEEL	NAME JP	DATE 18NOV13	Belden Incorporated www.beldenuniversal.com TITLE: ASSEMBLY, UNIVERSAL JOINT		
	ANGULAR MACHINED: $\pm 1.0^\circ$ FRACTIONAL: $\pm 0.015$ TWO PLACE DECIMAL: $\pm 0.010$ THREE PLACE DECIMAL: $\pm 0.005$ FOUR PLACE DECIMAL: $\pm 0.0005$ CONCENTRICITY: $0.0025$ T.I.R.	HEAT TREAT SEE DETAIL DRAWINGS	CHECKED ENG APPR. MFG APPR. Q.A. COMMENTS:	SIZE C		DWG. NO. UJ-LV5000	REV A
	PROPRIETARY AND CONFIDENTIAL THE INFORMATION CONTAINED IN THIS DRAWING IS THE SOLE PROPERTY OF BELDEN INC OR P R A T E D . ANY REPRODUCTION IN PART OR AS A WHOLE WITHOUT THE WRITTEN PERMISSION OF BELDEN INCORPORATED IS PROHIBITED.	ALL HOLES TO BE LOCATED ON CENTERLINE (C) WITHIN .005" T.I.R. INTERPRET GEOMETRIC TOLERANCES I.A.W. ANSI Y14.5M-1992	FINISH NONE	SCALE: 1:2		WT (Lbs): 74.411	SHEET 1 OF 2
	UNLESS OTHERWISE SPECIFIED CHAMFER ALL HOLES BREAK ALL SHARP CORNERS DE-BURR ALL FEATURES TURNED SURFACES: $\sqrt{63}$ MILLED SURFACES: $\sqrt{125}$						