

# APPROVED

## FOR REFERENCE ONLY

M5x0.8x5mm, SOCKET SET SCREW, CUP POINT, ALLOY STEEL 2X

REVISIONS				
ZONE	REV.	DESCRIPTION	DATE	APPROVED
	A	INITIAL RELEASE	5/30/2019	JP

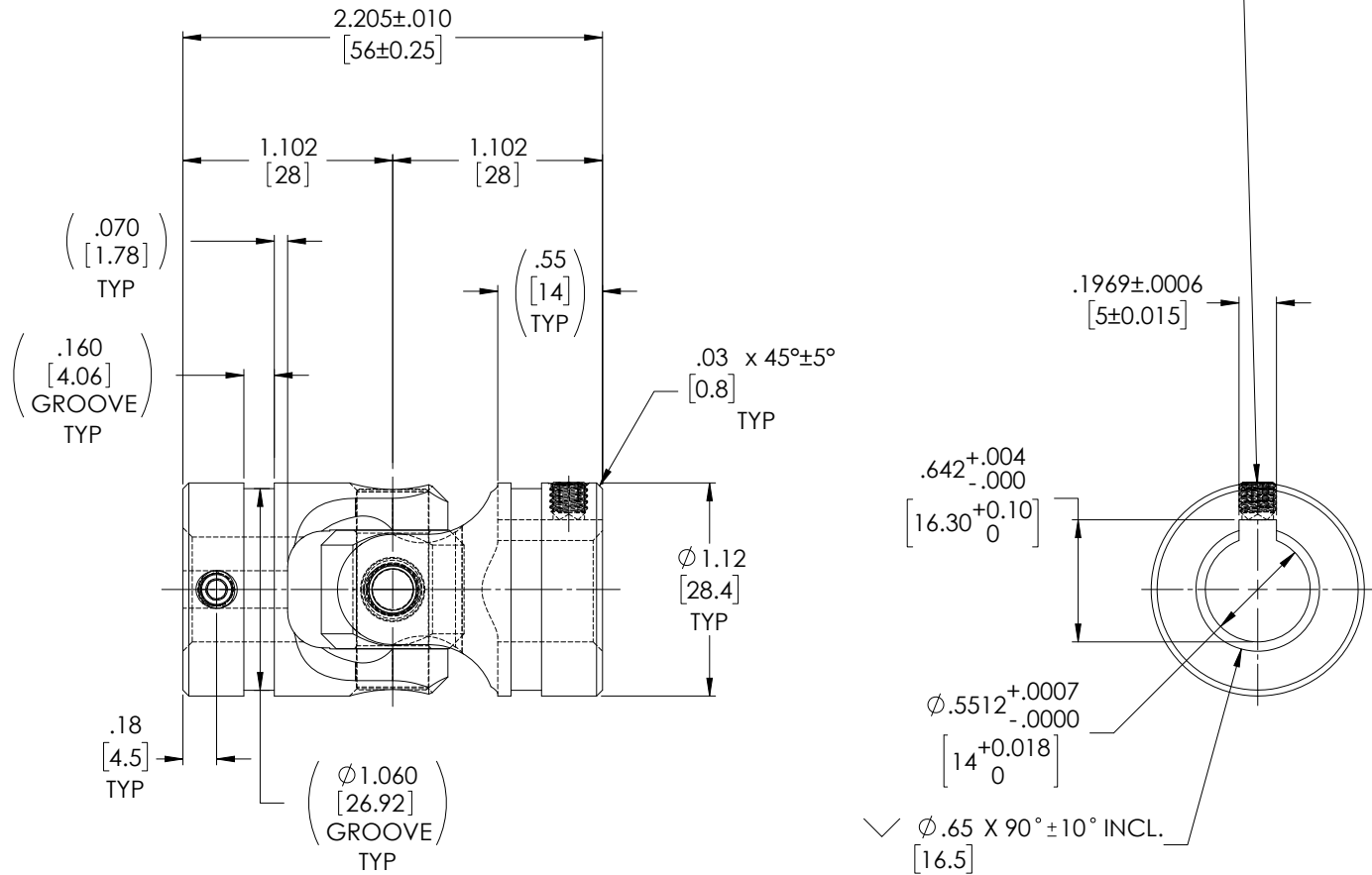
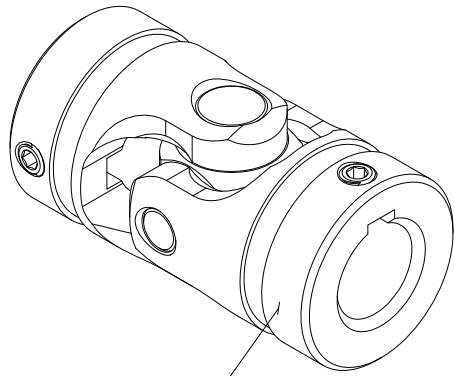

TYPICAL BOTH ENDS

NOTE(s), UNLESS OTHERWISE SPECIFIED.

1 MARK ASSEMBLY w/ "BELDEN" LOGO, PART NUMBER, REVISION LEVEL (IF ANY), DATE OF MANUFACTURE, & BELDEN JOB No.

(2) LUBRICATE U-JOINT w/ LUBRIPLATE # 1200-2, NLGI GRADE 2, AW/EP, LITHIUM GREASE OR EQUIVALENT.

(3) REF., MAXIMUM OPERATING ANGLE: 45°

DO NOT SCALE DRAWING

UNLESS OTHERWISE SPECIFIED CHAMFER ALL HOLES BREAK ALL SHARP CORNERS DE-BURR ALL FEATURES TURNED SURFACES: $\sqrt{63}$ MILLED SURFACES: $\sqrt{125}$ PROPRIETARY AND CONFIDENTIAL THE INFORMATION CONTAINED IN THIS DRAWING IS THE SOLE PROPERTY OF BELDEN UNIVERSAL. ANY REPRODUCTION IN PART OR AS A WHOLE WITHOUT THE WRITTEN PERMISSION OF BELDEN UNIVERSAL IS PROHIBITED.	STANDARD TOLERANCES, UNLESS OTHERWISE SPECIFIED DIMENSIONS ARE IN INCHES [mm] ANGULAR MACHINED: $\pm 1.0^\circ$ FRACTIONAL: $\pm .015^\circ$ TWO PLACE DECIMAL: $\pm .010^\circ$ THREE PLACE DECIMAL: $\pm .005^\circ$ FOUR PLACE DECIMAL: $\pm .0005^\circ$ CONCENTRICITY: $.0025^\circ$ T.I.R.	MATERIAL ALLOY STEEL	INITIALS    DATE DRAWN    JP    30MAY19	<b>Belden Incorporated</b> <a href="http://www.beldenuniversal.com">www.beldenuniversal.com</a> TITLE: <b>ASSEMBLY, UNIVERSAL JOINT</b>
	HEAT TREAT SEE DETAIL DRAWINGS	CHECKED    RNK    06/24/2019 ENG APPR.    RNK MFG APPR. QC APPR.	COMMENTS:	
	FINISH NONE	ALL HOLES TO BE LOCATED ON CENTERLINE (C) WITHIN .005" T.I.R. INTERPRET GEOMETRIC TOLERANCES I.A.W. ASME Y14.5	SIZE    DWG. NO.    REV <b>A</b> UJ-HD1125x14K <b>A</b>	
	SCALE: 2:1    WT (Lbs): 0.402    SHEET 1 OF 2			